

Rotary Outline Cutting Tool

WRT-5-001E-R1

ROTARY DIE CUTTER

MITSUBISHI MATERIALS HARDMETAL Rotary Die Cutter features high precision, quality, and durability by adopting Tungsten Carbide technology, precise grinding technology, and a detailed inspection process.

■ Applications



■ Long life and high quality cutting

- A combination of wear-resistant tungsten carbide (die cutter) and impact resistant tungsten carbide (anvil roll) delivers enables long life and high quality cutting.
- MITSUBISHI MATERIALS HARDMETAL produces a high quality and reliable cutting edge by using CAM process simulation and top-tier grinding technology.

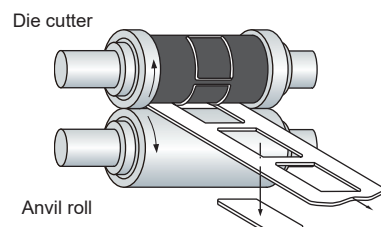

CAE simulation

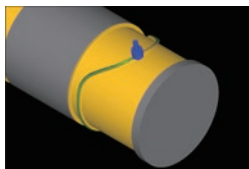

Detail of cutting edge



■ NCU Unit

- Easy to assemble or disassemble due to enough clearance.
- Zero clearance enables high accuracy assembling.
- Vibration is suppressed and contribute to stable production.

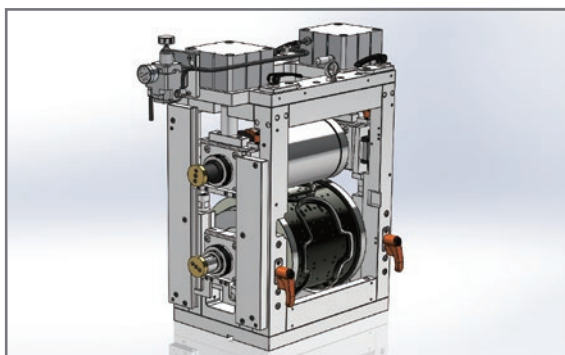

■ Pullex Unit

- Easy replacement for Anvil Roll.
- To exchange anvil roll, No need to disassemble RDC and unload unit from production line.
- Significant time reduction for replacing the Anvil roll.

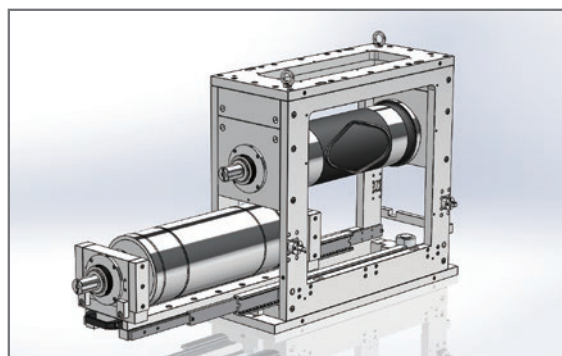

■ Quality Control and Assurance

- Precise measurement with CCD camera
CCD camera can measure edge condition and dimensions.

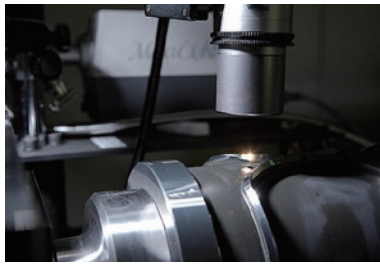

■ Product Testing

- In-house testing of cutting edge sharpness
We can test the sharpness of the RDC by using our original test cutting machine.

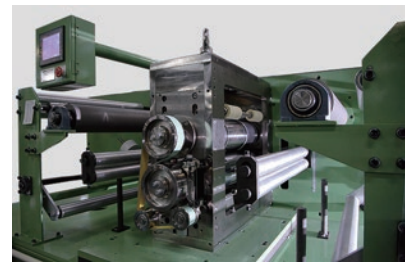

■ Custom Sizing

● Application ranges

Max. dimensions : O.D. Ø390mm, length 380mm
of carbide ring (Varies with proportionality of diameter and length)
Max. length : 1,600mm (Steel shaft length)
Max. weight : 500kg (Carbide ring + Shaft)

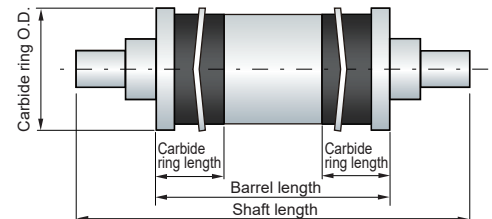

● Proven dimension (Carbide ring O.D. × Barrel length) × Shaft length

Adult diapers : (Ø340mm × 800mm) × 1,500mm
Baby diapers : (Ø272mm × 950mm) × 1,519mm
Sanitary napkins : (Ø 87mm × 250mm) × 600mm

Carbide material for die cutter



Carbide material for anvil roll



● Lineup

[Low-cost die cutter (Single-cutter : 1 pattern/rev.)]

- Compared with multi-cutter
- Light-weight, easy to handle
- Low cost



[Die cutter (Multi-cutter : 2-10 pattern/rev.)]

- General product



■ Customer Support and After-sales Service

● Detailed analysis, maintenance, and quick response

We have a sales network in more than 60 countries and provides the world's highest quality products, after-sales service, and tool maintenance.

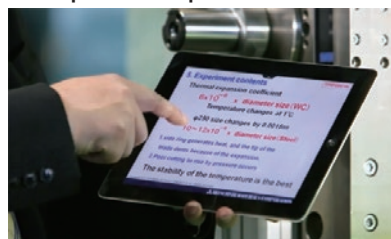

■ MITSUBISHI MATERIALS HARDMETAL CORPORATION

Tokyo Office Marunouchi Nijubashi Building 22F, 3-2-3, Marunouchi,
Chiyoda-ku, Tokyo 100-0005, Japan
TEL +81-3-5252-3871

Gifu Office 1528 Yokoi Nakashinden, Godo-cho, Anpachi-gun,
Gifu 503-2301, Japan
TEL +81-584-27-5419

Osaka Office OAP Tower, 28F, 1-8-30, Tenmabashi, Kita-ku, Osaka-shi,
Osaka 530-6070, Japan
TEL +81-6-6355-1052

<https://www.mmhm.co.jp/en/>

